

Tutorial how to use font opentype in Cricut Design Space

- Install the font for all user (format otf).
- Open Cricut Design Space and type some text

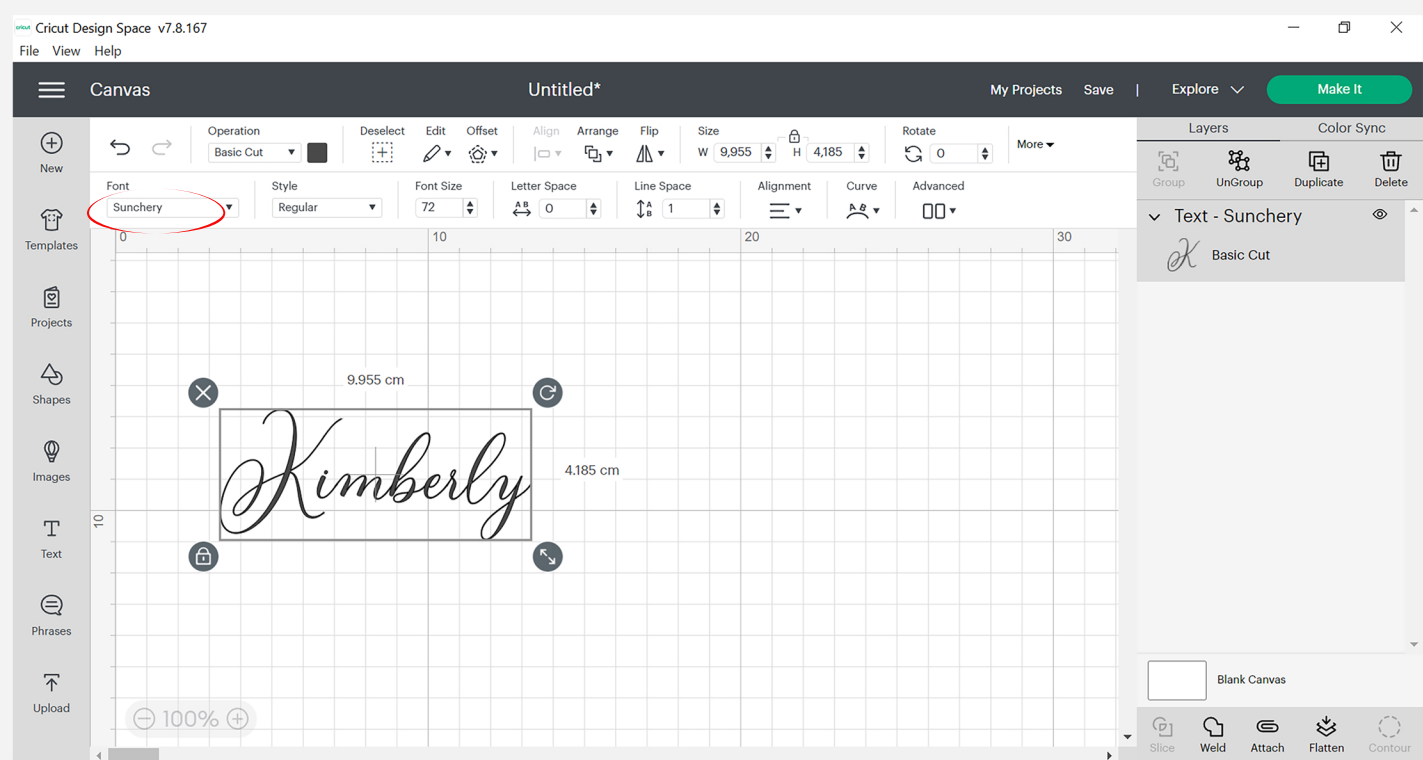

- Open Character map

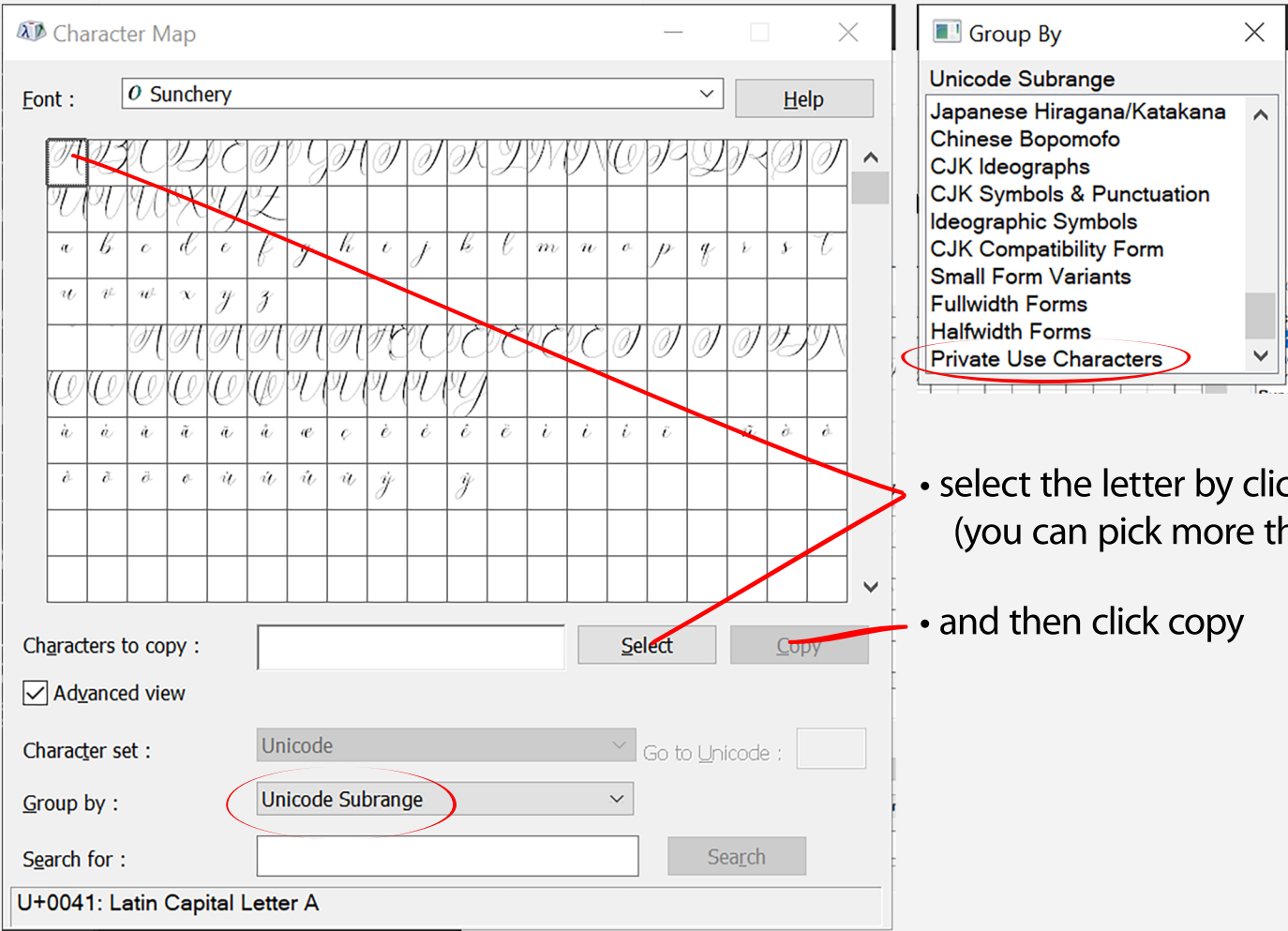

- Back to Cricut Design space and hen paste it into the text that was written earlier.

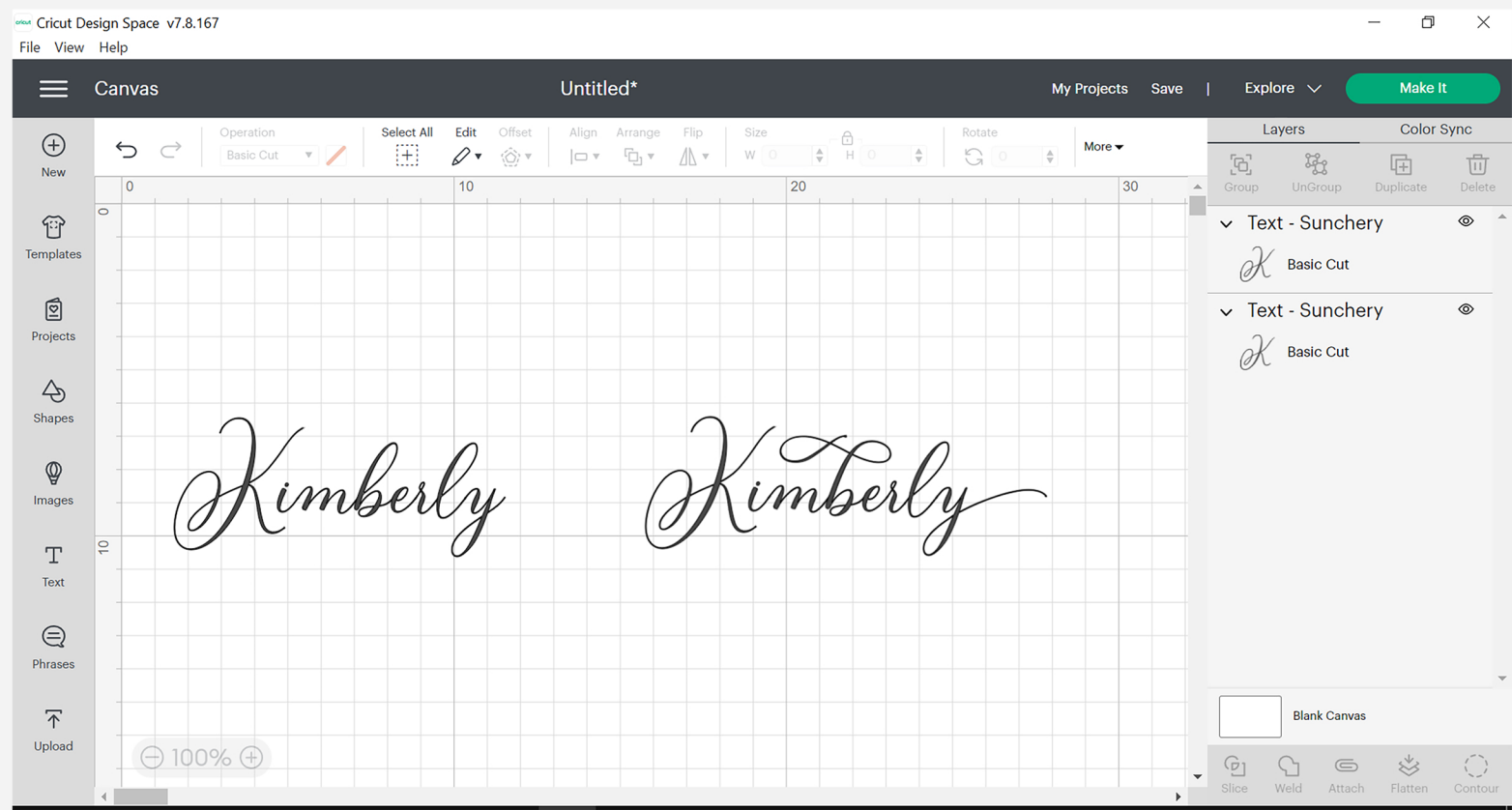

That's some tutorial how to use font opentype in Cricut Design Space.

Thank you hope you enjoy my fonts.